

HSE ROHS

REV	ECN NO	DESCRIPTION	DATE	NAME
A		NEW		

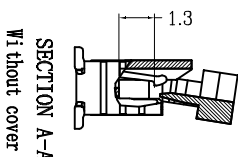
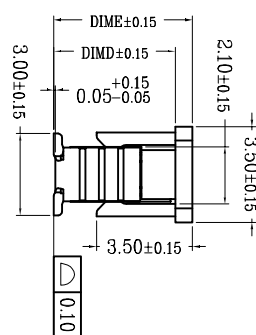
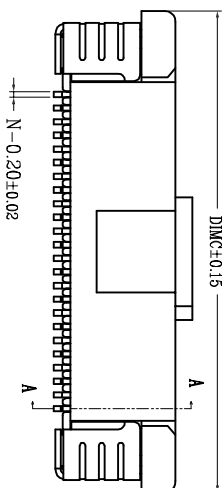
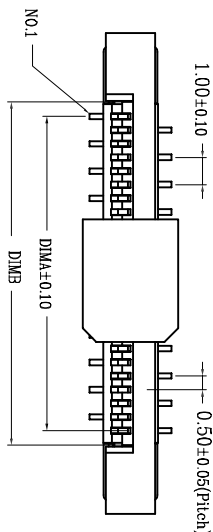

SECTION A-A
Without cover

- Note:
- Material
 - 1.1: Housing: LCP UL94-V0 Color:Black.
 - 1.2: Actuator: LCP UL94-V0 Color:Nature.
 - 1.3: Contact: Phosphor Bronze.
 - 1.4: LEG: Phosphor Bronze.
 - Plating
 - 2.1: Contact: Tin Plating Over Nickel.
 - 2.2: LEG: Tin Plating Over Nickel.
 - Rating:
 - 3.1: Operating Voltage: 50V AC/DC.
 - 3.2: Current Rating: 0.2A AC/DC.
 - 3.3: Operating Temperature:-25°C~+85°C.
 - 3.4: Contact Resistance:30 mΩ max.
 - 3.5: Insulation Resistance:100 MΩ min.
 - 3.6: Dielectric withstanding Voltage: AC 250V
 - Part Number:

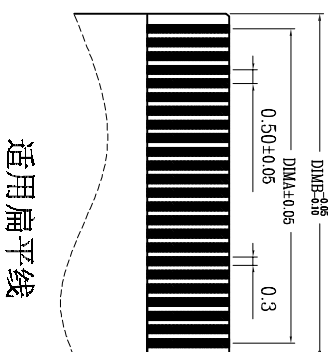
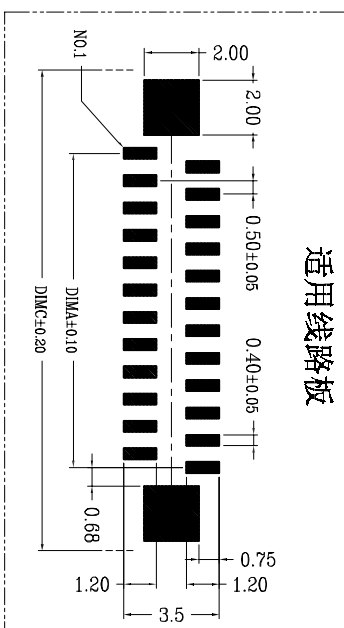
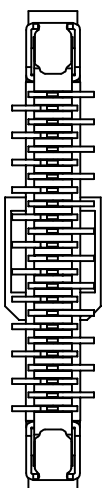

Ordering Information

L501XX-5 2 XX XX
 PIN 1=SMT Packing B=Tube D=Reel
 Contact Type 5=Single Contact With Cover Lock Insulation Height 8=4.45mm(4-34P) 9=5.00mm(35-60P)
 Serial NO. 01-99

QTY	DIM A	DIM B	DIM C	DIM D	DIM E
4	1.50	2.50	4.00		
5	1.50	2.50	4.00		
6	2.50	3.50	5.00		
7	3.00	4.00	5.00		
8	3.50	4.50	5.00		
9	4.00	5.00	5.00		
10	4.50	5.50	5.00		
11	5.00	6.00	5.00		
12	5.50	6.50	5.00		
13	6.00	7.00	5.00		
14	6.50	7.50	5.00		
15	7.00	8.00	5.00		
16	7.50	8.50	5.00		
17	8.00	9.00	5.00		
18	8.50	9.50	5.00		
19	9.00	10.00	5.00		
20	9.50	10.50	5.00		
21	10.00	11.00	5.00		
22	10.50	11.50	5.00		
23	11.00	12.00	5.00		
24	11.50	12.50	5.00		
25	12.00	13.00	5.00		
26	12.50	13.50	5.00		
27	13.00	14.00	5.00		
28	13.50	14.50	5.00		
29	14.00	15.00	5.00		
30	14.50	15.50	5.00		
31	15.00	16.00	5.00		
32	15.50	16.50	5.00		
33	16.00	17.00	5.00		
34	16.50	17.50	5.00		
35	17.00	18.00	5.00		
36	17.50	18.50	5.00		
37	18.00	19.00	5.00		
38	18.50	19.50	5.00		
39	19.00	20.00	5.00		
40	19.50	20.50	5.00		
41	20.00	21.00	5.00		
42	20.50	21.50	5.00		
43	21.00	22.00	5.00		
44	21.50	22.50	5.00		
45	22.00	23.00	5.00		
46	22.50	23.50	5.00		
47	23.00	24.00	5.00		
48	23.50	24.50	5.00		
49	24.00	25.00	5.00		
50	24.50	25.50	5.00		
51	25.00	26.00	5.00		
52	25.50	26.50	5.00		
53	26.00	27.00	5.00		
54	26.50	27.50	5.00		
55	27.00	28.00	5.00		
56	27.50	28.50	5.00		
57	28.00	29.00	5.00		
58	28.50	29.50	5.00		
59	29.00	30.00	5.00		
60	29.50	30.50	5.00		

LDCONN 东莞连大精密制品有限公司
 Dongguan LianDa Precision Products Co., LTD

STANDARD TOLERANCE (EXCEPT SPECIFIED)	LINER	ANGLES
.0 ±0.30	0.°	±3°
.00 ±0.20	.0°	±2°
.000 ±0.10	.00°	±1°

TITLE	P100 5mm PFC Vertical SMT type with lock	DRAWN BY	WZG	DATE	17.03.30
PART NO	L501XX-52XXXX	CHECKED BY			
DRAWING NO		APPROVED BY			
SCALE	1:1	UNITE	mm	PAGE	1/1
				SIZE	A4